

Weld On Lifting Point Townley

Product information

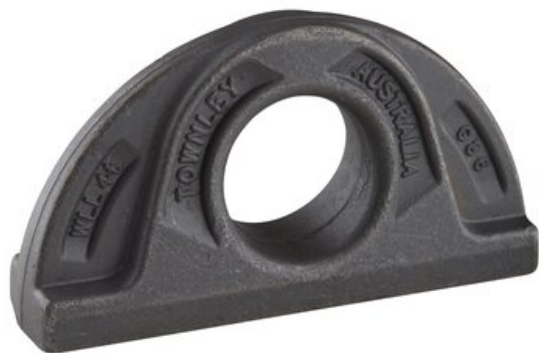

Pad Eye Weld On Lifting Points from Townley.

General:

- Multi-directional loading
- Ideal for lifting and lashing
- Welding will always be carried out by a qualified welder under AS 1554.1.2014

Material: Alloy



Finish: Phosphate Black

Safety factor: 4:1

Grade: 10

Part Code	Code	WLL ton	A mm	B mm	C mm	D mm	E mm	Weight (kg)
4215DPLP160	DPLP160	1.6	100	24	30	42	18	0.4
4215DPLP250	DPLP250	2.5	130	28	35	48	20	1
4215DPLP400	DPLP400	4	160	38	45	62	22	1.6
4215DPLP670	DPLP670	6.7	180	46	60	76	28	2.8
4215DPLP1000	DPLP1000	10	240	70	80	100	36	5.8

Technical data

Working Load Limits (tonnes)				
Part No.				
	Single Point	2, 3 or 4 point <i>Maximum Included Angle</i>		
		60°	90°	120°
DPLP160	1.6	2.8	2.2	1.6
DPLP250	2.5	4.4	3.4	2.5
DPLP400	4.0	7.0	5.5	4.0
DPLP670	6.7	11.7	9.2	6.7
DPLP1000	10.0	17.5	13.7	10.0

Blueprint

